

# Quick User Guide - Orderman7 - Emulation Max/Don/Sol

DE: Vollständige Anleitung auf [www.orderman.com](http://www.orderman.com) verfügbar

EN: Full manual available at [www.orderman.com](http://www.orderman.com)

Version 00.02 Draft

Nr.: 497-0506659



## Drucker Verbinden bei Max/Don und Sol Emulation/ Connect printer for Max/Don and Sol Emulation

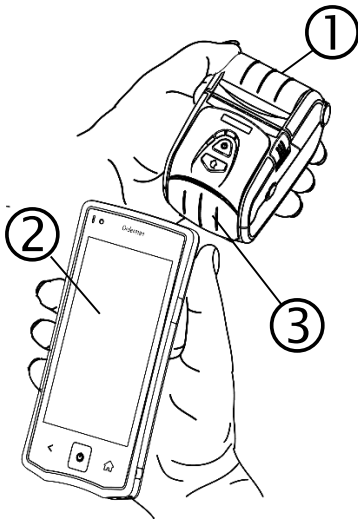

- ① Gürteldrucker/ Belt printer
- ② Orderman Handheld
- ③ Drucker Vorderseite Printer, front

### DE:

- ▶ *Max/Don Emulation:* Halten Sie die Taste < am Handheldgerät links unten gedrückt bis das Settings Menü geöffnet wird.
- ▶ *Sol Emulation:* Tippen Sie auf die Kellner Taste  am Display links oben bis das Settings Menü geöffnet wird.
- ▶ Tippen Sie auf **Pairing**.
- ▶ Tippen Sie auf **Pair printer now**.
- ▶ Halten Sie den Gürteldrucker wie in der Abbildung dargestellt an das Handheld (Vorderseite des Druckers an rechte obere Kante des Handhelds).
- ▶ Testdruck des Gürteldruckers wird ausgedruckt, der Drucker ist verbunden.

### EN:

- ▶ *Max/Don Emulation:* Press and hold the < key on the lower left of the handheld until the Settings menu is displayed.
- ▶ *Sol Emulation:* Tap the Waiter key  at the upper left of the display until the Settings menu opens.
- ▶ Tap to select **Pairing**.
- ▶ Select **Pair printer now**.
- ▶ Hold the belt printer to the handheld unit as shown in the figure (hold the front of printer to the upper right corner of the handheld).
- ▶ The test printout for the belt printer is now printing; the printer is now connected.

## Tastenbelegung ändern bei Max/Don Emulation/ Reconfiguring key assignments for Max/Don Emulation

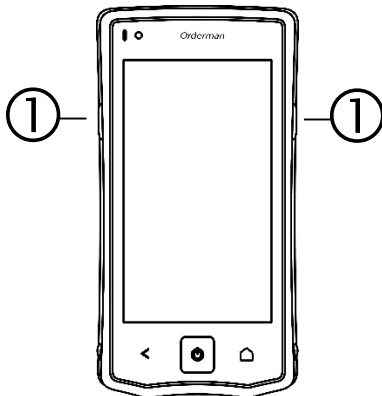

- ① Frei belegbare Hardwaretasten/  
Freely configurable hardware keys

### DE:

- ▶ Drücken Sie auf die Taste < am Handheldgerät links unten bis das Settings Menü geöffnet wird.
- ▶ Tippen Sie auf **Miscellaneous** und dann auf **Button Mapping**.
- ▶ Um die jeweilige Taste zu belegen, tippen Sie auf **Right button action** oder **Left button action** und auf die Aktion mit der Sie die Taste belegen möchten.

Mögliche Aktionen sind:

**Scroll menucard:** Die Menükarte ist vergrößert dargestellt und kann mit der belegten Taste nach oben/unten gescrollt werden.

**Toggle full menucard display:** Die Menükarte wird vergrößert/verkleinert dargestellt.

**Perform menucard:** Die Taste kann mit bestimmten Funktionen aus der Menükarte belegt werden.

### EN:

- ▶ Press and hold the < key on the lower left of the handheld until the Settings menu is displayed.
- ▶ Tap to select **Miscellaneous** and then select **Button Mapping**.
- ▶ To assign a key to an action, tap **Right button action** or **Left button action** and select the action you want to assign to the key.

Possible actions are:

**Scroll menu card:** The menu card is displayed in zoom format and can be scrolled up/down.

**Toggle full menu card display:** The menu card is displayed in enlarged/reduced format.

**Perform menu card:** The key can be assigned to specific functions from the menu card.



## Collegamento della stampante con l'emulazione Max/Don e Sol/ Conexión de impresora en la emulación Max/Don y Sol

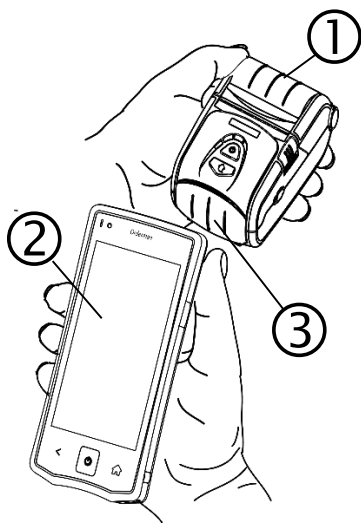

- ① Stampante da cintura/  
Impresora de cinturón
- ② Palmare Orderman/  
Telecomanda Orderman
- ③ Lato anteriore della stampante/  
Parte delantera de la impresora

### IT:

- ▶ *Emulazione Max/Don*: premere il tasto < sul palmare in basso a sinistra finché non si apre il menu Settings.
- ▶ *Emulazione Sol*: premere il tasto Cameriere  sul display in alto a sinistra finché non si apre il menu Settings.
- ▶ Toccare su **Pairing**.
- ▶ Toccare su **Pair printer now**.
- ▶ Tenere la stampante da cintura verso il palmare come mostrato nella figura (lato anteriore della stampante sul bordo destro superiore del palmare).
- ▶ Viene effettuata la stampa di prova, la stampante da cintura è collegata.

### ES:

- ▶ *Emulación Max/Don*: Mantenga pulsada la tecla < de la parte inferior izquierda de la telecomanda hasta que se abra el menú Settings.
- ▶ *Emulación Sol*: Pulse la tecla de camarero  en la parte superior izquierda de la pantalla hasta que se abra el menú Settings.
- ▶ Pulse **Pairing**.
- ▶ Pulse **Pair printer now**.
- ▶ Coloque la impresora de cinturón junto a la telecomanda tal y como se muestra en la ilustración (parte delantera de la impresora en el borde superior derecho de la telecomanda).
- ▶ Se realiza una impresión de prueba con la impresora de cinturón. La impresora está conectada.

## Modifica dell'assegnazione dei tasti con l'emulazione Max/Don/ Cambiar la asignación de teclas en la emulación Max/Don

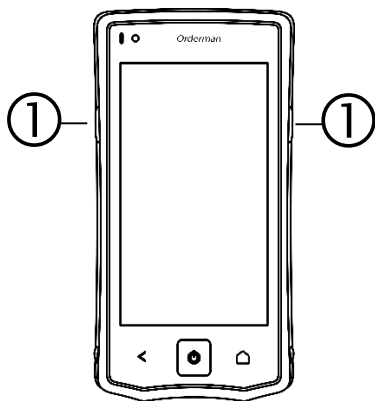

- ① Tasti dell'hardware ad assegnazione libera/  
Teclas de hardware de asignación libre

### IT:

- ▶ Premere il tasto < sul palmare in basso a sinistra finché non si apre il menu Settings.
- ▶ Toccare su **Miscellaneous** e successivamente su **Button Mapping**.
- ▶ Per assegnare i tasti toccare su **Right button action** o su **Left button action** e sull'azione da assegnare al tasto.

Sono possibili le azioni seguenti:

**Scroll menucard**: rappresentazione ingrandita della menucard e possibilità di scorrere la menucard verso l'alto e il basso con il tasto assegnato.

**Toggle full menucard display**: rappresentazione ingrandita o ridotta della menucard.

**Perform menucard**: si possono assegnare al tasto alcune funzioni della menucard.

### ES:

- ▶ Pulse la tecla < de la parte inferior izquierda de la telecomanda hasta que se abra el menú Settings.
- ▶ Pulse **Miscellaneous** y, seguidamente, **Button Mapping**.
- ▶ Para asignar la tecla correspondiente, pulse **Right button action** o **Left button action** y la acción que desea asignar a la tecla.

Las acciones posibles son:

**Scroll menucard**: la carta de menú se representa ampliada y puede desplazarse hacia arriba/hacia abajo con la tecla asignada.

**Toggle full menucard display**: la carta de menú se representa ampliada/reducida.

**Perform menucard**: es posible asignar a la tecla determinadas funciones de la carta de menú.

# NCR Orderman7 EMU Firmware upgrade

## System Center

Type	Serial Number	Status	Version / Availabl...	Channel	Progress
 OMB2	54736	Normal	7.64 / 1.1 7.64 / 1.1	42	

Waiting for Handhelds ...

## Firmware update Max

Radio 

Type	Serial Number	Status	Version	Available	Progress
 Max2	38561	Normal (radio)	1.0.2.2015...	1.0.3.2015	

Cradle 

Type	Serial Number	Status	Version	Available	Progress
 Max2	38561	Normal (cradle)	1.0.2.2015...	1.0.3.2015	

Type	Serial Number	Status	Version	Available	Progress
 Max2	38561	Normal (cradle)	1.0.2.2015...	1.0.3.2015	

- Upgrade Firmware
- Update Beltprinter-Images
- Upload Menucard

Type	Serial Number	Status	Version	Available	Progress
 Max2	38561	Updating Firmware	1.0.2.2015	1.0.3.2015	<div style="width: 42%;"></div> 42%

Type	Serial Number	Status	Version	Available	Progress
 Max2	38561	Normal (cradle)	1.0.3.2015	1.0.3.2015	

## Firmware update Sol

Cradle 

Type	Serial Number	Status	Version	Available	Progress
 Sol+ MSR NFC	38594	Normal (cradle)	1.0.2.2015	1.0.3.2015	

Type	Serial Number	Status	Version	Available	Progress
 Sol+ MSR NFC	38594	Normal (cradle)	1.0.2.2015	1.0.3.2015	

- Request Logfiles
- Upgrade Firmware
- Update Beltprinter-Images
- Request Status
- Request Setup

Type	Serial Number	Status	Version	Available	Progress
 Sol+ MSR NFC	38594	Updating Firmware	1.0.2.2015	1.0.3.2015	<div style="width: 42%;"></div> 42%

Type	Serial Number	Status	Version	Available	Progress
 Sol+ MSR NFC	38594	Normal (cradle)	1.0.3.2015	1.0.3.2015	

